



Steps to Measuring Your Kitchen:

- 1) Take 4 pictures of your current kitchen. Wall 1, 2, 3 & 4. This insures quality designs and eliminates many mistakes made by other websites and designers. Save Files as Wall 1, 2, 3 & 4 when emailing or uploading.

Example Pictures:



Wall 1



Wall 2



Wall 3



Wall 4

- 2) Measure entire Wall lengths; no matter if a door, cabinet/base, appliance, or window is there.
- 3) Complete the Window/Doorway Dimension's; including the trim on both.
- 4) Complete the Appliance Measurement Box.
- 5) Complete Miscellaneous Question Box.
- 6) Provide Sketch (see additional FAQ's section) if having questions or call our Design Team. Important to note the distance from corner to any window or door, then measure other side of window or door to end of wall/cabinet location. Also, include floor to window height.



Wall Length Dimensions:

Wall #1	
Wall #2	
Wall #3	
Wall#4	
Floor To Ceiling	

Window/Door Dimensions (include trim)

Window Height x Width Wall: _____	
Window Height x Width Wall: _____	
Window Height x Width Wall: _____	
Door Height x Width Wall: _____	
Door Height x Width Wall: _____	

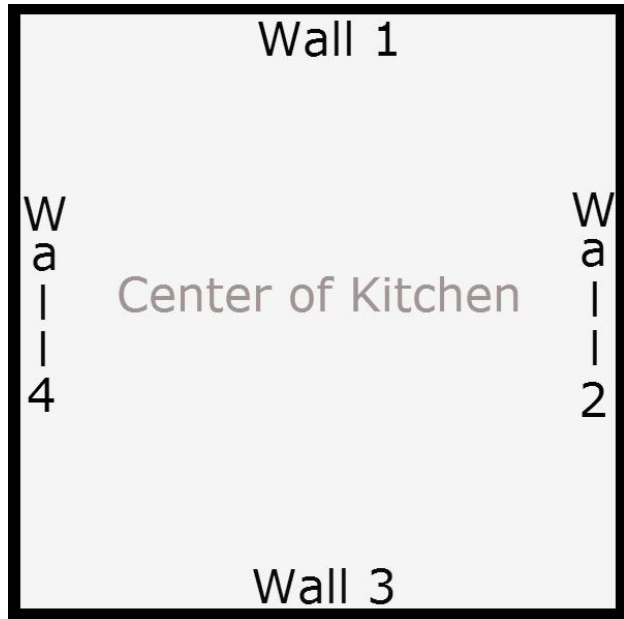

Miscellaneous Info (circle when applicable)

Do you have a soffit?	If yes, what is the height of soffit? _____		
Can/do you want to remove soffit?	Yes	No	
Current Wall Cabinet Height:	30"	36"	39" 42" 48" other _____
Cabinet Height Above Range:	12"	15"	18" 21" 24" other _____
Cabinet Height Above Refrigerator:	12"	15"	18" 21" 24" other _____
Do you prefer Soft Close Hinges & Drawers?	Yes	No	Not Sure Yet
Do you need Hardware (knobs)?	Yes	No	Not Sure Yet
Planning to move or are you okay with moving gas line?	Yes	No	Please include in drawing
Planning to move or are you okay with moving plumbing/water line?	Yes	No	Please include in drawing
Do you want Add-On's in Drawing? (circle all that apply)	Plate Rack	Wine Rack	Spice Cabinets Roll Out Trays
	Decorative Panels	Crown Molding	Light Rail Molding
Do you want Mullion/Glass Doors?	Yes	No	
Do you have any special requests (door opening direction, cabinet door clearance or passage clearance area)	Please list each...		

Appliance Measurements:

Refrigerator	W _____ x H _____ x D _____	Range Hood	W _____ x H _____ x D _____
Stove	W _____ x H _____ x D _____	Sink	W _____ x H _____ x D _____
Dishwasher	W _____ x H _____ x D _____	Oven (wall)	W _____ x H _____ x D _____
Microwave	W _____ x H _____ x D _____	Trash Compactor	W _____ x H _____ x D _____

Drawing

- Please measure each wall from corner to corner (or to end of countertop/base if no corner). Measure entire wall, no matter if a door, cabinet/base, window or appliance being used. Use feet and inches per each wall.
- Measure the exact distance of water, gas and/or electric line that comes from floor and/or wall. If in wall we need to know the exact distance from wall corner (note which wall) and distance from the floor.
- Include distance from corner to window and from other side of window to end of wall/cabinet space. Also, include floor to window height.



FAQ's

Q: How accurate do my measurements need to be?

A: Very, 1" could result in wrong cabinets being ordered, delivered, and not fitting in your space. This is the customer's responsibility.

Q: I like the drawing and have selected the cabinet style I want, now what?

A: We will send a disclaimer for the drawing and material list that you will sign off on. Damage or missing items will be replaced at no charge. If wanting to return any of the items for other reasons than the above mentioned, there is a 20% re-stocking fee and you're responsible for the return shipping. Any damages in the return will not receive credit.

Q: Do I only measure the window and door or do I include the trim in the measurement?

A: Include the trim on windows and door measurements.

Q: How do I note I have a wall mounted oven that uses a gas or electric line?

A: We need the exact feet and inches from a corner wall and height from floor that it comes through the wall.

Q: How do I sketch a countertop that ends needs near another wall or appliance?

A: Include in drawing and note the amount of "open" distance between wall/appliance and the countertop.

Q: Our door opens/swings into the kitchen area, how do I note this?

A: Not only do you need to sketch each door in or near the kitchen, you need to identify which way it opens. If into the kitchen our designers will note this and the provided pictures you give us will identify this already.

Q: We currently have (or want to include) an island in our kitchen, how do I sketch this?

A: We need you to not only sketch the dimensions of the base cabinets but include the countertop dimensions. This is critical to determine if select drawers/doors can open if space is limited. Additionally we need to know the exact distance from a wall (note which wall measuring from) if any water, disposal or if other "lines" come out of the floor.

Additional Notes:

If you are putting in new appliances, make sure to note the height, width, and depth, of any new stoves, dishwashers, and refrigerators ready at the time of design. If you will be getting new services such as a water line for an icemaker, or under cabinet outlets or water filters, wine racks, or garbage disposal, please indicate this as well during the design phase.